

# Product Information

---

---

## 2 Wire system Signal Amplifier

---

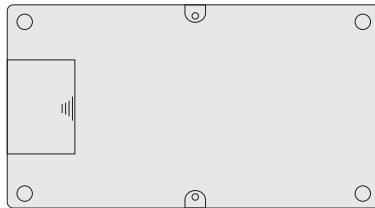

### DESCRIPTION

2 wire system signal amplifier

### DIMENSION

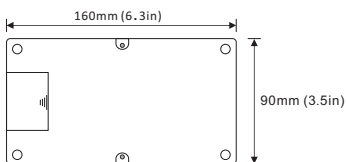

### FEATURES

- ▶ BUS amplifier unit
- ▶ Extend the distance of the system

## 1. Parts and Functions

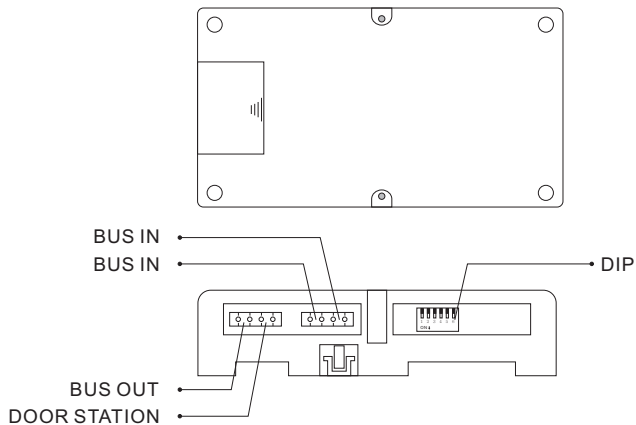

## 2. Installation

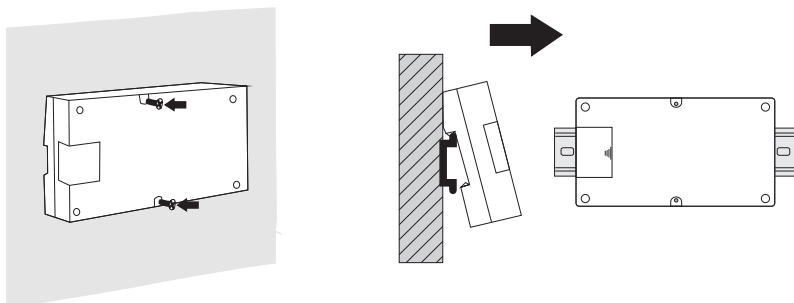

Direct wall-mounted

DIN-Rail mounted

## 3. Specification

Power Supply	DC 24V
Power Consumption	Standby 13.5 mA, Working 156mA
Wiring	2 wire, non-polarity
Working Temperature	-10°C ~ +60°C
Dimension	160(H) ×90(W) ×40(D)mm 6.3 (H) ×3.5 (W) ×1.6(D)in