

6. DIP Switches Settings

Total 6 bits in the DIP switches can be configured. The switches can be modified either before or after installation.

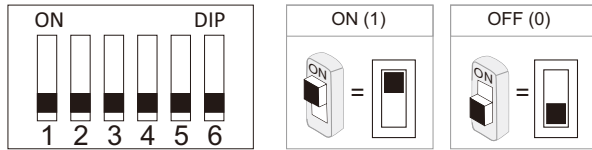

Bit-1, Bit-2 and Bit-3 are used for door station ID setting (I=on, 0=off).

000 - 100 - 010 - 110 - 001 - 101 - 011 - 111

000 - First door station

100 - Second door station

010 - Third door station

110 - Fourth door station

If there's extra camera connected with the system. The door station ID would be

000 - First door station

010 - Second door station

001 - Third door station

011 - Fourth door station

Bit-4 and Bit-5 is used for unlock time setting.

00 - 1 second (Default setting)

10 - 5 seconds

01 - 10 seconds

11 - 15 seconds

Bit-6 is used for connecting extra camera.

0 - No extra camera (Default setting)

1 - Connecting with extra camera

7. Electric Lock Connection

1. The door lock power for a 12v DC strike (max current=250mA).
2. Set the jumper SIP1 set to 1-2 for a normally closed lock (power OFF to open), or set SIP1 to 2-3 for a normally open lock (power ON to open).
3. Adjust the timer setting with Bit-4 and Bit-5 at the outdoor station (I=on, 0=off)

00-1sec, 01-5sec, 10-10sec, 11-15sec

Power ON to open

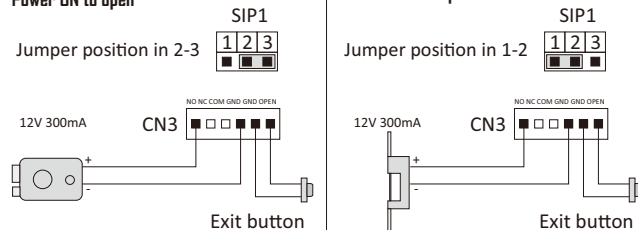

Power OFF to open

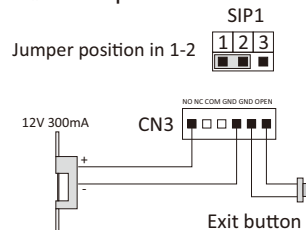

8. Electric Lock Connection

1. The external power supply must be used according to the lock.
2. The jumper must be taken off before connecting.
3. If different unlocking time is needed, change the unlock time on door station by modifying the BIT-4 and BIT-5.

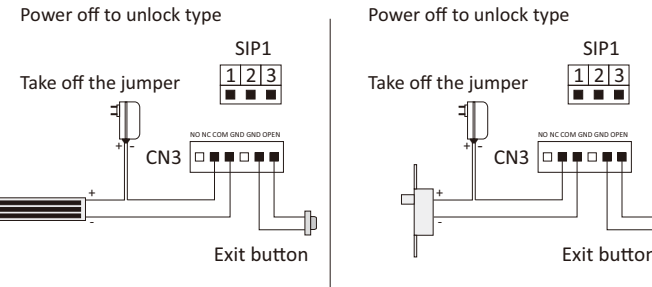

9. Specification

- Power supply: DC 24V
- Power Consumption: 1W in standby, 5W in working
- Unlock Power output: 12Vdc, 250mA
- Unlock timing: 1s, 5s, 10s, 15s
- Working Temperature: -20°C~ +55°C

The design and specifications can be changed without notice to the user. Right to interpret and copyright of this manual are preserved.

Door Station

2-wire Door Station

Quick Installation Guide

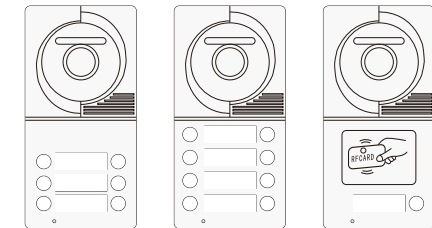
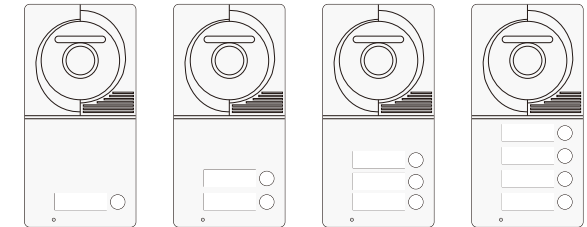

1. Parts and Functions

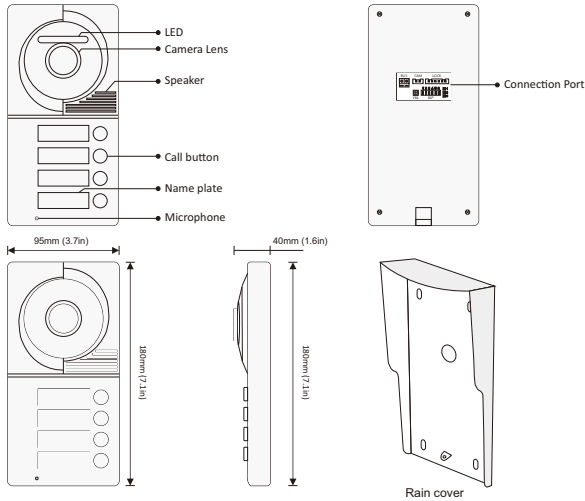

2. Terminal Description

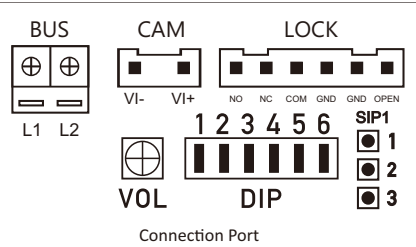

- BUS: (L1, L2) non-polarity bus line
- CAM: Extra camera connection port
- LOCK: Electronic lock connection port
- VOL: Volume adjustor
- DIP: DIP switches for system configurations.

3. Place Name Label

Press down and move left to open the transparent nameplate cover. Then insert the name paper and put the cover back.

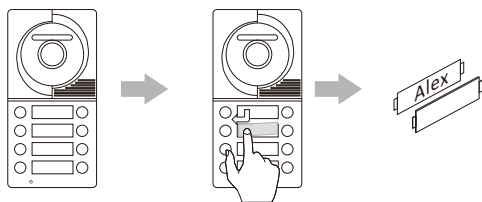

4. Mounting

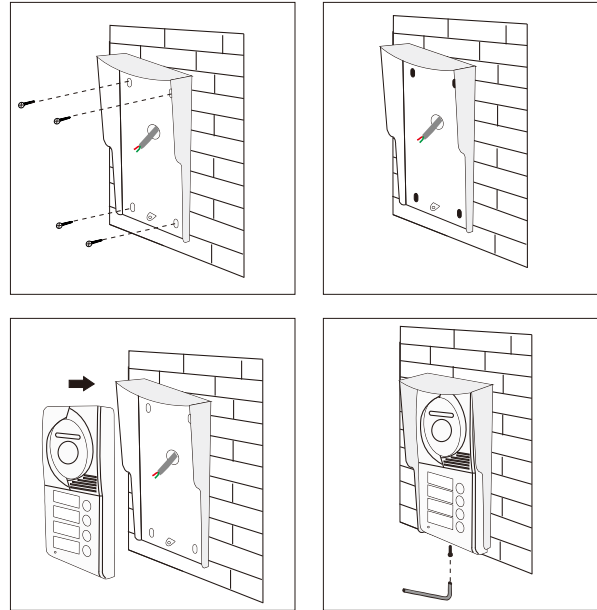

5. System Connection

Multi door station

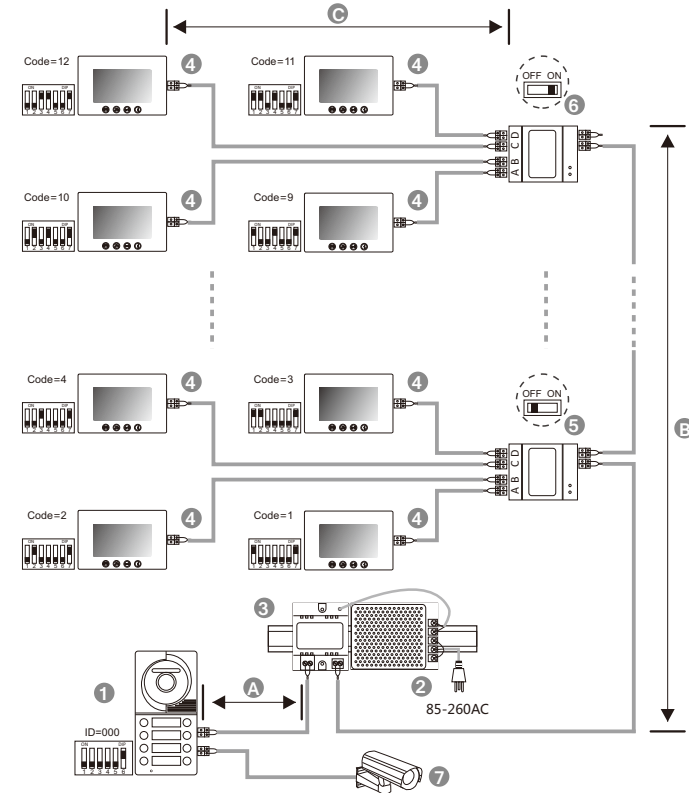
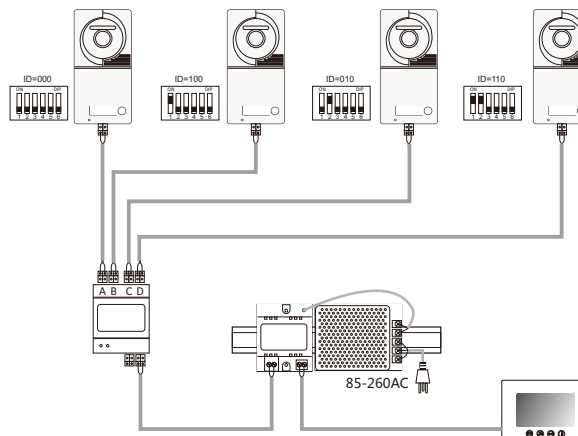

When monitor quantity < 20

Cable Usage	A	B	C
Parallel cable 2x0.75mm	60	60	30
Parallel cable 2x1mm	80	80	40

When monitor quantity > 20

Cable Usage	A	B	C
Parallel cable 2x1mm	60	60	30
Parallel cable 2x1.5mm	80	80	40

[1]: Door station, when there is only one Door station, the DIP bit-1, bit-2 and bit-3 should be set to 000.

[2]: Power supply, MUST be installed side by side with Power Separator.

[3]: Power Separator, MUST be installed side by side with Power supply.

[4]: Monitor, each one with a unique User Code, note that all the bit-6 of the DIP should be set to 1(ON) in this case.

[5]: Video distributor set switch to OFF unless at the end of the line.

[6]: Video distributor set switch to ON at the end of the line.

[7]: Extra camera.